

Letter of Intent for Special Use Permit Application
Auto Glass Now #331- Snellville GA

The Applicant, Auto Glass Now, Agent for Owner/Contract Lessee, hereby submits application for Special Use Permit for use as an auto glass repair facility at .31 acres located at 2564 Main St. W. Snellville, Georgia, herein referred to as "the Property," as shown in the attached boundary survey and more particularly described in the attached Legal Description.

The Property is located in the City of Snellville, Georgia and is zoned BG (Business General). Upon approval of a special use permit, Auto Glass Now does not intend to modify the use of the site configuration or current setbacks applied to the property. Therefore the Property is consistent with the allowable uses under the Special Use Permit and surroundings.

The Intent of the Applicant is to convert the vacated JiffyLube shop into an auto glass repair and replacement facility. This work is to include exterior paint per samples provided and re-signage to Auto Glass Now branding.

Auto Glass Now offers the most reliable auto glass repair and replacement services nationwide. We repair and replace windshields as well as all your auto glass needs with industry leading quality and safety standards by removing broken glass and providing a new window with warranty. We also repair and fill chips to windows to prevent crack from forming or spreading.

Applicant believes this use is in conformity with the surrounding area and a fulfil general need to the community it will serve. Please feel free to reach out to our development team directly with any questions you may have.

Jeannette.Lucas@drivenbrands.com

714-905-6124

Thank you!

RECEIVED
MAR 6 2023
CITY OF SNELLVILLE
PLANNING & DEVELOPMENT

FRONT ELEVATION
AUTO GLASS NOW
 2564 Main St W
 Snellville, GA 30078

UL Underwriters Laboratories Inc. •
 UL File #E225670

Copyright Notice ©
 This drawing and all
 components are the property
 of Signs Unlimited, Inc. and
 may not be reproduced, modified,
 or used in any way without
 written permission.

PROOF

Sq. Ft. Signage:
 32.70

Signage Allowance:
 37.50 Sq. Ft.

(5% of Wall; 36 Sq. Ft. Min)
 Zoned BG, City of Snellville

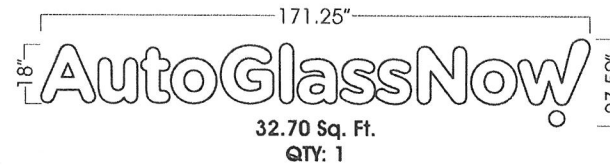

INITIAL LAYOUT:
 February 3, 2023

REVISIONS:
 2/9/23

ADDITIONAL ELEMENT
ALUMINUM PAN

Size: As in drawing
 Thickness: 1"
 Face Color: Painted Black w/ White & Blue Vinyl
 Edge Color: Painted Black
 Mounting: Angle
 Location: TBD

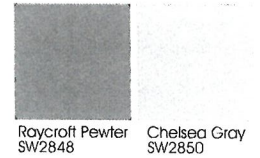
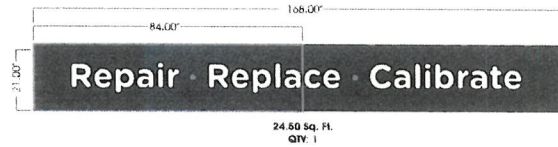

IMPOSED IMAGERY

SPECIFICATIONS

**ILLUMINATED
 CHANNEL LETTERS**

Size:
 As in drawing
 Trim:
 1"

Trim Color:
 Black or White

Return Color:
 Black or White

Face Color:
 As in drawing

Face:
 1/8" Acrylic

Letter Interior:
 Gloss White

Illumination:
 LED

Mounting:
 Studded Letters

**PAINTING HANDLED BY GC/OWNER
 PRIOR TO INSTALLATION**

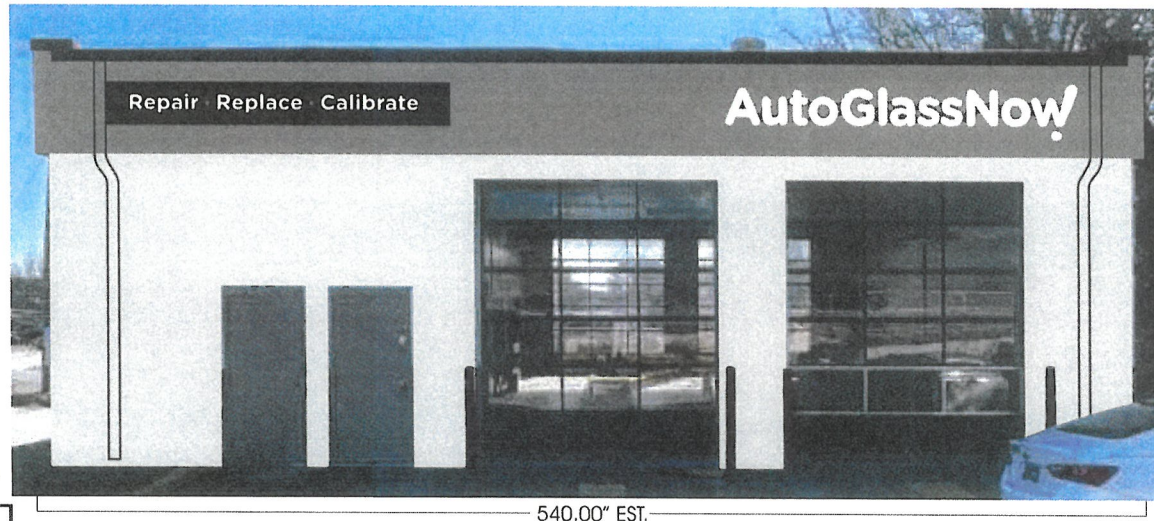

DETAIL

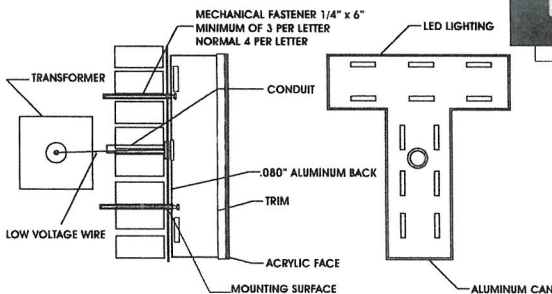

NOTES:

- IF ELECTRICAL LINE/J-BOX IS WITHIN 6' OF ELECTRICAL, CONNECTION TO BE HANDLED BY INSTALLER.
- IF NOT ELECTRICAL HANDLED BY GC/OWNER.
- IF ROOF PENETRATIONS ARE NECESSARY, THEY ARE TO BE SEALED BY A ROOFER. HANDLED BY THE GC/OWNER.
- REMOVAL AND DISPOSAL OF EXISTING WALL SIGNS HANDLED BY GC/OWNER

Owner/Landlord Approval _____

SIGNS:UNLIMITED
 communicate your identity

6801 Mount Hermon Church Rd Durham, NC 27705 • (P) 919-552-8689 • (F) 919-557-1322

REAR ELEVATION
AUTO GLASS NOW
 2564 Main St W
 Snellville, GA 30078

UL Underwriters Laboratories Inc. •
 UL File #E225670

Copyright Notice ©
 This drawing and all
 contents are the property
 of Signs Unlimited, Inc. and
 are either trademarks or registered
 designs of Signs Unlimited, Inc. and
 shall not be used without
 express consent.

PROOF

Sq. Ft. Signage:
 32.70

Signage Allowance:
 37.50 Sq. Ft.
 (5% of Wall; 36 Sq. Ft. Min)
 Zoned BG, City of Snellville

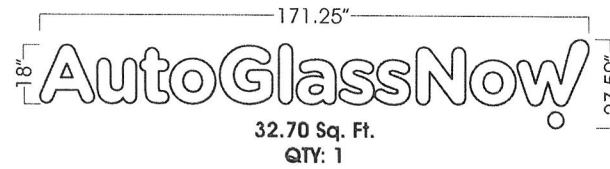

72.00"

INITIAL LAYOUT:
 February 9, 2023

REVISIONS:

ADDITIONAL ELEMENT
ALUMINUM PAN

Size: As in drawing
 Thickness: 1"
 Face Color: Painted Black w/ White & Blue Vinyl
 Edge Color: Painted Black
 Mounting: Angle
 Location: TBD

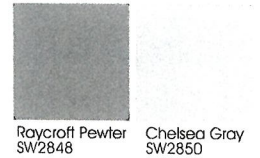
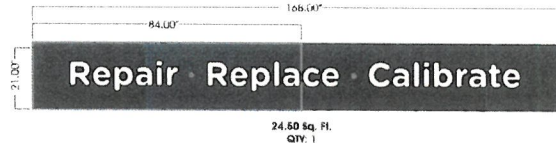

IMPOSED IMAGERY

SPECIFICATIONS

**ILLUMINATED
 CHANNEL LETTERS**

Size:
 As in drawing
 Trim:
 1"
 Trim Color:
 Black or White
 Return Color:
 Black or White
 Face Color:
 As in drawing
 Face:
 1/8" Acrylic
 Letter Interior:
 Gloss White
 Illumination:
 LED
 Mounting:
 Studded Letters

PAINTING HANDLED BY GC/OWNER
 PRIOR TO INSTALLATION



DETAIL

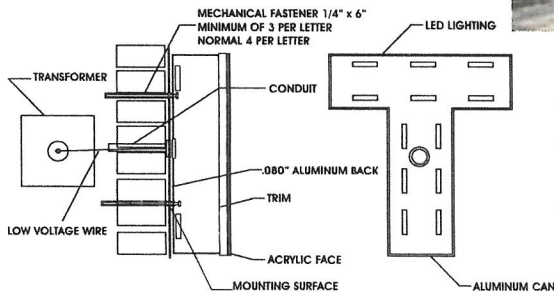

NOTES:
 • IF ELECTRICAL LINE/J-BOX IS WITHIN 6' OF ELECTRICAL, CONNECTION TO BE HANDLED BY INSTALLER.
 IF NOT ELECTRICAL HANDLED BY GC/OWNER.
 • IF ROOF PENETRATIONS ARE NECESSARY, THEY ARE TO BE SEALED BY A ROOFER. HANDLED BY THE GC/OWNER.
 • REMOVAL AND DISPOSAL OF EXISTING WALL SIGNS HANDLED BY GC/OWNER

Owner/Landlord Approval _____

SIGNS UNLIMITED
 communicate your identity

6801 Mount Hermon Church Rd Durham, NC 27705 • (P) 919-552-8689 • (F) 919-557-1322

DOOR VINYL
AUTO GLASS NOW
 2564 Main St W
 Snellville, GA 30078

UL Underwriters Laboratories Inc. •
 UL File #E225670

Copyright Notice ©

This drawing and all
 its contents are the property
 of Signs Unlimited, Inc. and
 may not be reproduced, modified,
 distributed or used in any way without
 written consent.

INITIAL LAYOUT:

February 3, 2023

REVISIONS:

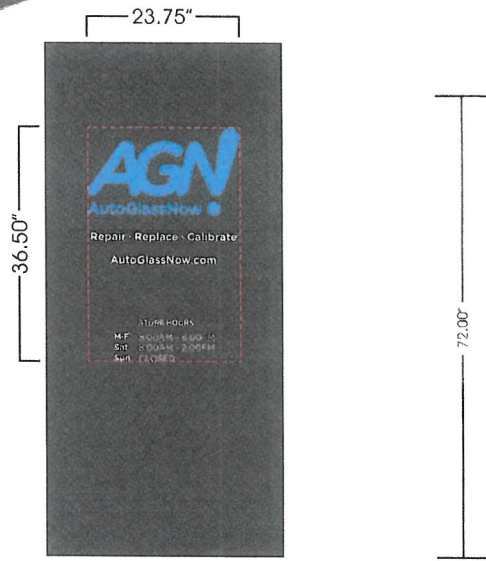

6.02 Sq. Ft.
 QTY: 1

PROOF
 Sq. Ft. Signage: 6.02
 Signage Allowance: 6.02
 N/A - Not Counted as Signage

IMPOSED IMAGERY



EXISTING CONDITIONS



SPECIFICATIONS

**NON-ILLUMINATED
 DOOR VINYL**

- Size:** As in drawing
- Material:** Non-illuminated cut vinyl
- Mounting:** Directly onto glass 1st surface

Owner/Landlord Approval _____

6801 Mount Hermon Church Rd Durham, NC 27705 • (P) 919-552-8689 • (F) 919-557-1322

SIGNS UNLIMITED
 communicate your identity

AUTO GLASS NOW

2564 Main St W
Snellville, GA 30078



Underwriters Laboratories Inc. •
UL File #E225670

Copyright Notice ©

This document is the property of Signs Unlimited, Inc. and shall not be reproduced, stored in a retrieval system, or transmitted in any form or by any means, electronic, mechanical, photocopying, recording, or otherwise, without the prior written permission of Signs Unlimited, Inc.

INITIAL LAYOUT:

February 3, 2023

REVISIONS:

2/9/23

AutoGlassNow!

Repair · Replace · Calibrate

Repair · Replace · Calibrate

AutoGlassNow!



Owner/Landlord Approval _____

6801 Mount Hermon Church Rd Durham, NC 27705 • (P) 919-552-8689 • (F) 919-557-1322

Garage Entrance



Garage Exit



Left Side of Building



Right Side



For the top of the building we can use Roycroft Pewter by Sherwin Williams:

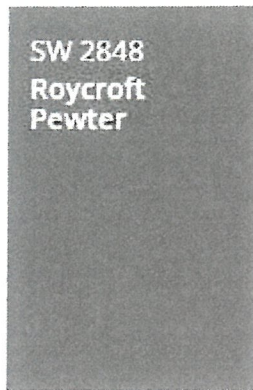

For the bottom we will use Chelsea Gray by Sherwin Williams:

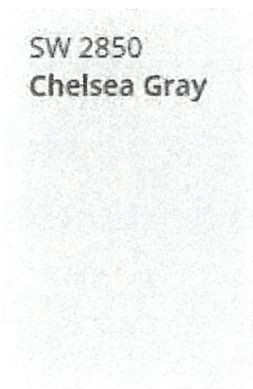

Both of these colors are in the Sherwin Williams Historic Colors Palette as requested.

The steel posts out front will be painted in the blue pictured below and will not exceed the 10% brand color that is allowed per ordinance.

SW-6958 Dynamic Blue

