

FILE PATH: E:\PROJECTS\2017\17235A-10-SADDLEBROOK PH2\DWG\17235A-OVERALL SITE PH 1.DWG - 2018-08-20 - DAWN WATSON

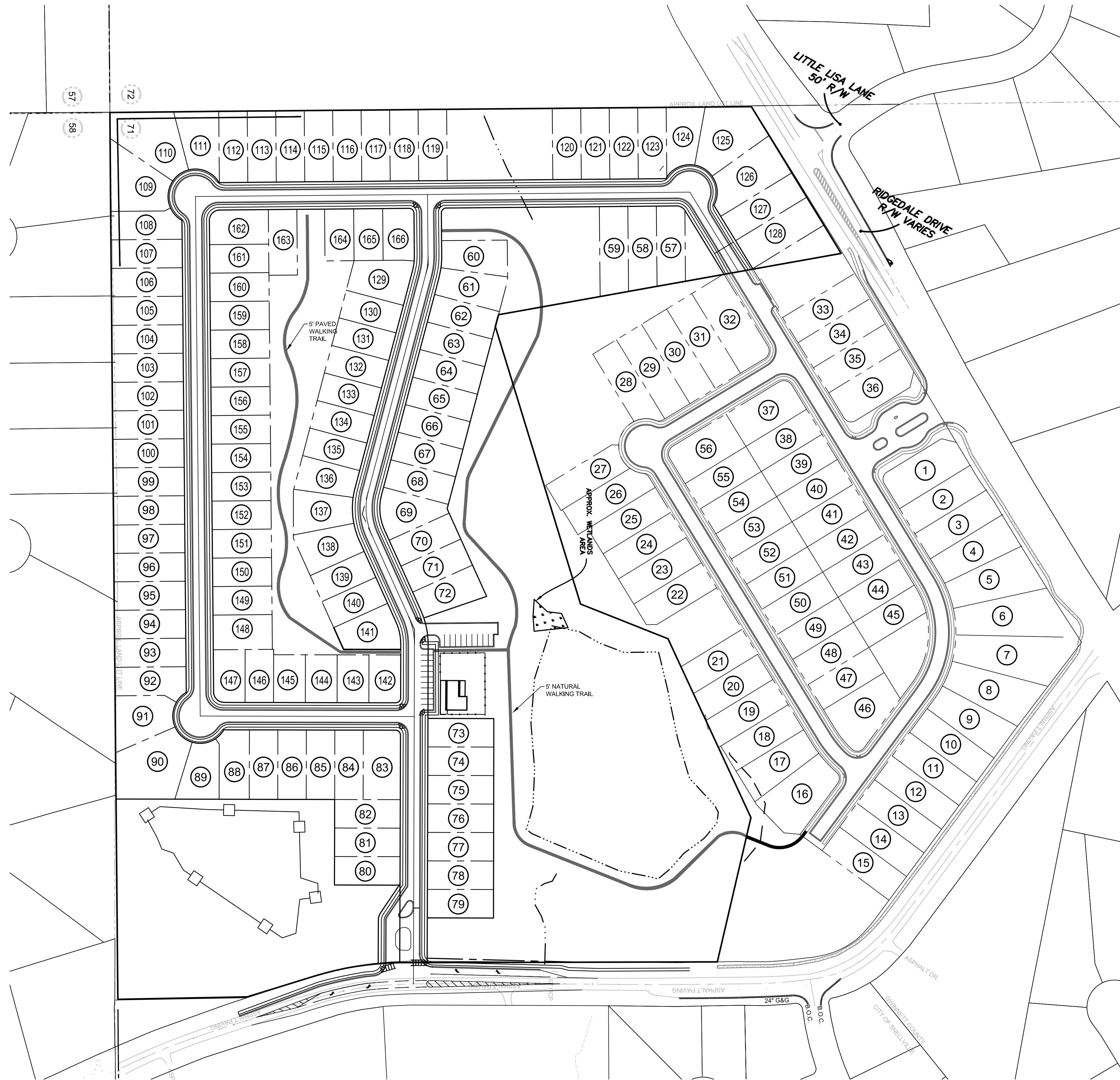

	PHASE 1	PHASE 2	TOTAL
5' TYPICAL SIDEWALKS	8,894.33 L.F.	8,194.90 L.F.	17,089.23 L.F.
5' WIDE NATURAL WALKING TRAIL	123.75 L.F.	3,682.35 L.F.	3,806.10 L.F.
5' WIDE PAVED WALKING TRAIL		1,974.97 L.F.	

* MEASUREMENTS TO BE USED FOR ANNEXATION PURPOSES ONLY.

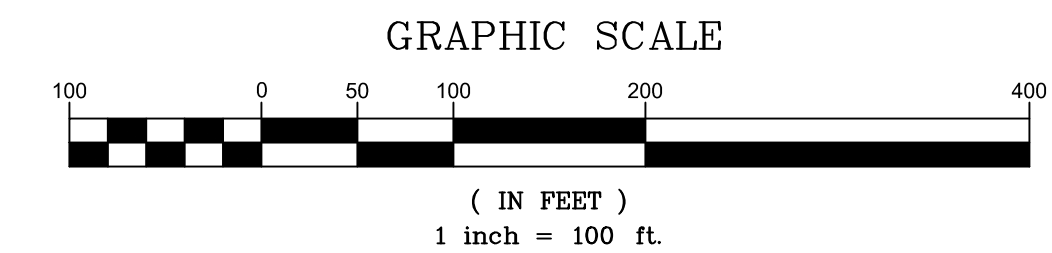

© 2017
PRECISION PLANNING, INC.
ALL RIGHTS RESERVED.

THESE CONSTRUCTION DOCUMENTS AND ANY INSTRUMENTS OF SERVICE ARE THE SOLE PROPERTY OF PRECISION PLANNING, INC. AND ARE TO BE USED ONLY FOR THE PROJECT AND SITE SPECIFICALLY INDICATED HEREON. ANY REUSE OR REPRODUCTION OF THESE DOCUMENTS WITHOUT THE WRITTEN CONSENT OF PRECISION PLANNING, INC. IS STRICTLY PROHIBITED.

STAMP

PRECISION
Planning Inc.

planners • engineers • architects • surveyors

400 Pike Boulevard, Lawrenceville, GA 30046
770.338.8000 • www.ppi.us

**SADDLEBROOK
SUBDIVISION
PHASES 1 & 2**

PINEHURST ROAD DISTRICT,
LAND LOTS 58, 71, 83, 100, 108, 118,
128, 138, 148, 158, 168
GWINNETT COUNTY, GEORGIA

OVERALL SITE PLAN			
SHEET TITLE			
DESIGN	DRAWN	CHECKED	WDL
DMW	DMW		

DATE	NO.	DESCRIPTION

08-20-2018
DATE

R17-235a
PPI PROJECT NO.

1 of 1