

FUTURE GROWTH - MORE THAN A POP UP MARKET

**By Eric Van Otteren,
Economic Development Director**

New ideas about what the Towne Center @ Snellville might offer in the future are being developed following a spring Town Hall meeting hosted by Mayor Tom Witts and City Council members.

Working behind the scenes, staff continues to explore possibilities, especially the relocation of the library and establishing a permanent city market – something that is not found elsewhere in Gwinnett County.

The idea for a city market, similar to the Krog Street or Sweet Auburn city markets in downtown Atlanta, came about after the appearance of a surprising Pop-up Market in the spring of 2015 on the Wisteria property across the street from the Snellville Police Department. The headline in a Snellville Spirit article at the time stated, “Snellville’s Wisteria City Market to set the stage for future growth.”

Well, who would have guessed that the Pop-up Market would spark great conversations including a potential relocation of the Snellville branch of the Gwinnett County library and the establishment of a permanent City Market?

The concept for the library is a building on the city owned Wisteria Drive property. The first floor of the building would be the City Market. The second floor would be the new location for the Snellville branch of the Gwinnett library. An additional floor would be available for offices for the City Market as well as space for local businesses. Associated with the Market/Library building would be a detention lake, walking trail and terraced lawn. There is also consideration for the remaining land to be used for future office/campus development.

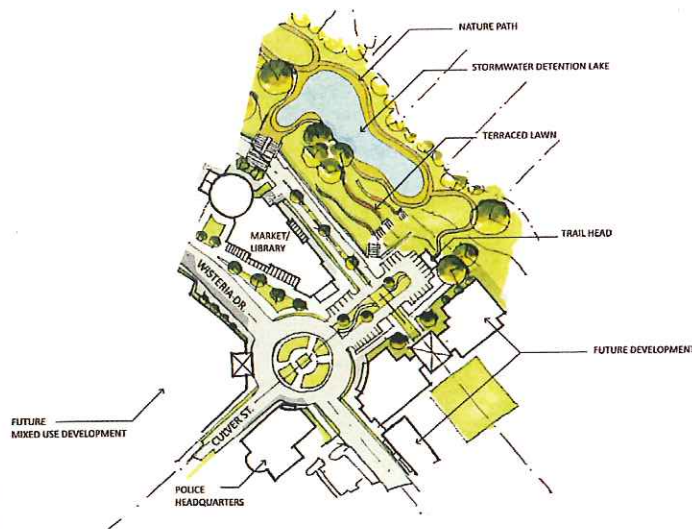

City leaders are listening to your input. Renewed conversations about the Towne Center @ Snellville from the Town Hall meeting and other conversations are keeping all these ideas alive. City leaders are now engaging in conversations about next steps. The long considered roundabout proposed in the 2003 Livable Centers Initiative is back on the drawing board along with additional on-street parking. There is also talk of a landscape design concept for the west side of City Hall.

The grand opening of the new Towne Green was a great first step. The Towne Green provides a safe place for the Snellville Farmers’ Market, concerts and many other community events.

The coming Special Local Option Sales Tax decision this fall provides the opportunity for the consideration of these additional ideas and more. If you would like to be part of the conversation, participate in future town hall meetings and visit Snellville’s new Web Site Community Conversation page: www.snellville.org/the-conversation. City leaders welcome your insights and comments in the discussion forums.

Be part of imagining the Towne Center @ Snellville. City leaders are listening and acting on community input. This will not happen without you. To misquote a recently released “Star Trek” movie, “punch-it Mayor Witts.”



Snellville, Where Everybody’s Proud to be Somebody